

INDEX	PART#	DESCRIPTION	QTY
1	11220-02	DFTR, 8"W FOR WOOD TIE W/ANTI SLIP	2
2	11233-04	DUCT, TRACK 8*4*96" INT/PLAIN	2
3	11233-10	DUCT, TRACK 8*4*48" EXT/CAP	2
4	11236	DUCT, TRACK 8*4*96" FLGD	2
5	14295-02	DFTR, 18"W FOR WOOD TIE W/ANTI SLIP	2
6	15157	BRKT, TD 2.19"H ADJ 8"TD SH	10
7	17173-01_LEFT	NOZ ASSY, SH POINT END, RAIL MTG TDUCT	1
8	17173-01_RIGHT	NOZ ASSY, SH POINT END, RAIL MTG TDUCT	1
9	17739	TRACK DUCT SUPPORT, GAUGE PLATE	2
10	17899-01	ELBOW, TD 8*4" QDISC FLTG TIE	2

TITLE	TRACKDUCT SYS, SH TIE>8*4**20' W/TIE	DRAWING NUMBER	REV.
		17842	E SHT. 1/1

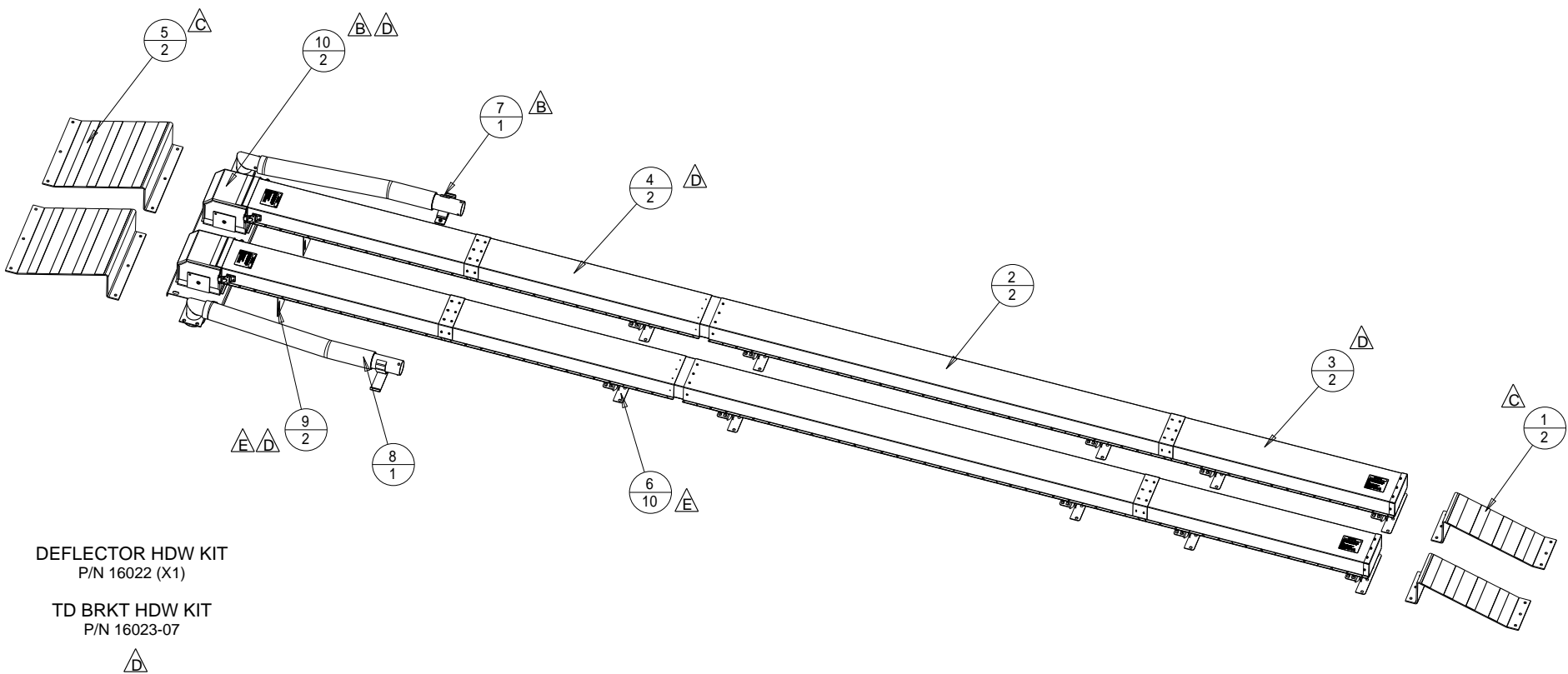

WOOD-TIE CONFIGURATION

MATERIAL SEE INDIVIDUAL PART DRAWINGS

SCALE AS SHOWN

UNLESS OTHERWISE SPECIFIED DIMENSIONS ARE IN INCHES

XX ± 0.03
XXX ± 0.01

ANGLES ± 0.5 °
OTHER _____

HOVEY INDUSTRIES 2005 INC

DWN GTM DATE DWN 25NOV2010 CHKD DATE

DWG SIZE	A1		
REV	DESCRIPTION	DATE	CHKD
E	REDRAWN IN PRO-E. 17739 X2 WAS 15152 X4 15157 X10 WAS X8. ECN 2405	25NOV2010	GTM
D	11236 WAS 11232, 48" WAS 96", QTY CHANGE 16023-07 WAS -01. ECN 1693	27FEB2003	TMH
C	ANTI SLIP VARIANT DEFLECTORS -02 WERE -01. ECN 1437	15JAN2002	CCB